

SABER TOOTH TRASH DISC ASSEMBLY

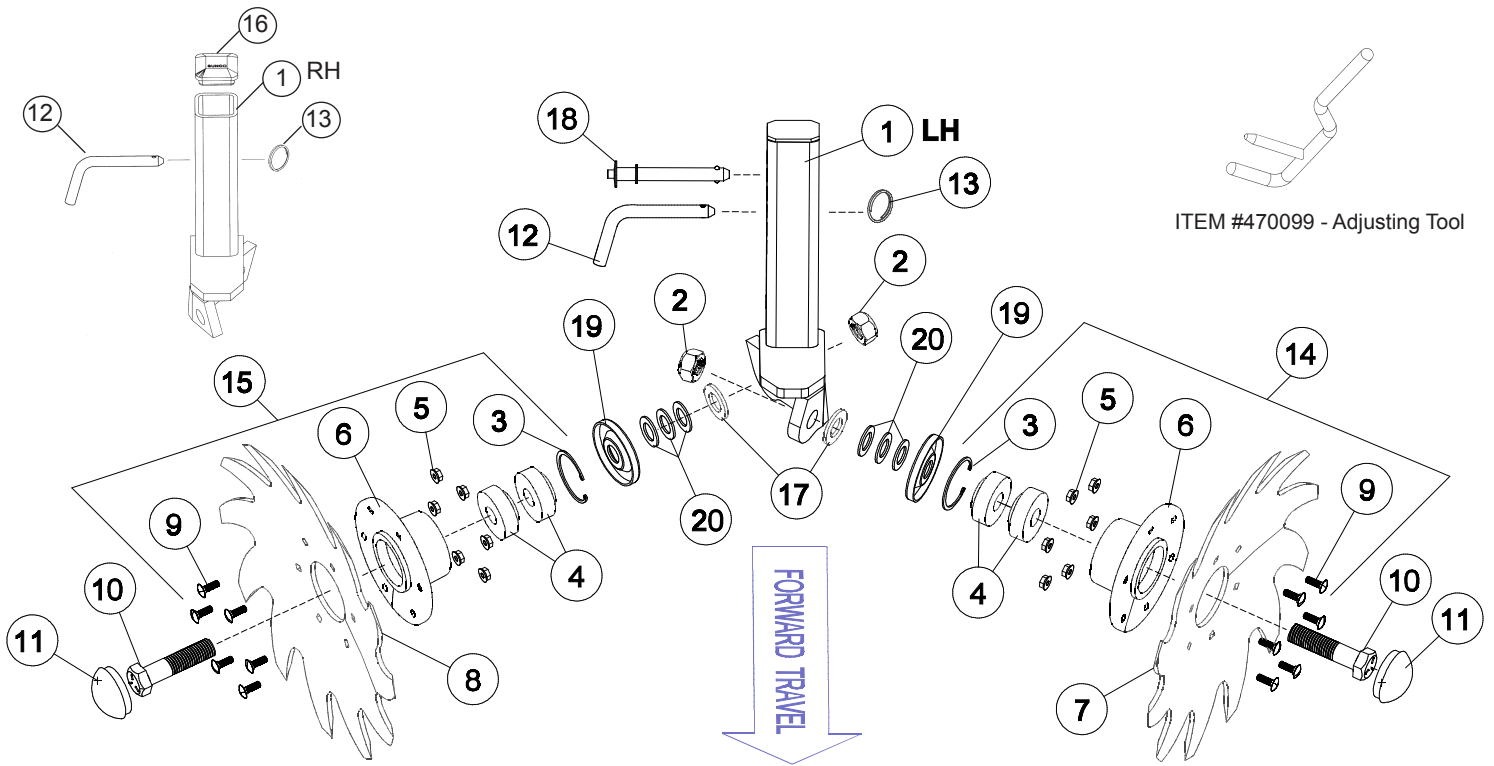

Item	Part #	Description	Qty
1	SEE PAGE 4-2		
2	201152	Nut 3/4 Hex Center Lock	2
3	204385	Snap Ring X 2 Internal	2
4	210030	Bearing 2 X .75 205KRP2 (JD=A27002)	4
5	201108	Nut 1/4 Flange Whiz Lock	12
6	210079	Hub Trash Disc	2
7	166015	Disc Blade 13" Saber Tooth Left	1
	166025L	18" Disc	1
8	166016	Disc Blade 13" Saber Tooth Right	1
	166025R	18" Disc	1
9	200114	Carriage Bolt 1/4 X 7/8 Gr. 5	12
10	200406	HHCS 3/4 X 3 1/2 Gr. 5	2
11	210089	Hub Cap	2
12	360202 (optional)	Bent Pin	1
13	203141 (optional)	Ring - Kickout 1 1/4"	1
14	3012603	13" Disc-Hub-Bearing Assy LH (incl. items 3,4,5,6,7 & 9)	1
	3012612L	18" Disc-Hub-Bearing Assy LH	1
15	3012604	13" Disc-Hub-Bearing Assy RH (incl. items 3,4,5,6,8 & 9)	1
	3012612R	18" Disc-Hub-Bearing Assy RH	1
16	220027	Plug Rubber 2" Square: Note: May have welded cap (#360021)	1
17	202220	Washer 3/4 Flat SAE Hardened Plated (used with 13" Discs)	2
	360045	Spacer 1.56 OD x .82 ID x .63 (used with 18" Discs)	2
18	360205	Pin - Quik Adjust Pin	1
19	360054	Bearing Shield 2.7 x .34	2
20	202404	Machine Bushing 3/4 x 1 1/4 x 14 Ga.	6

FOR PLANTER MOUNT PART NUMBERS - REFER TO PAGE 4-3